

Double Angle (DA) Collet Systems



Drilling

- DA-style Erickson collet system provides true gripping for drills at greater cutting speeds and feed rates.
- DA-style collets keep the drill short for greater accuracy.
- Maximum collapse is .031 (0,8 mm).
- Main application: drilling.

ERICKSON

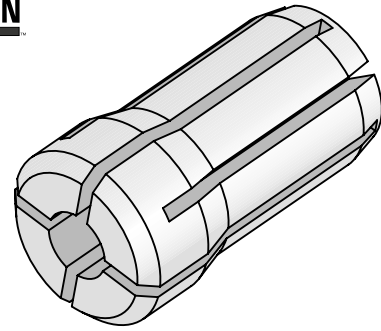

DA-Style Collet Identification System

System Size

100
180
200
300

Special Features

C = coolant style - bonded
NP = non-pullout Weldon (end mill design)

Unit Size

M = metric
" " = (left blank) collet number built in inch units.

180

DA

C

160

M

Collet Style

DA - Erickson
Double Angle

Collet Bore Size

metric 010 = 1 mm
(xx.x) 160 = 16 mm

inch 0125 = 1/8"
(x.xxx) 0500 = 1/2"

DA Collet Accuracy

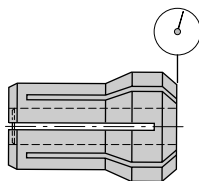

.001 (0,025 mm) TIR
at collet nose

DA-Style Collet

Maximum Runout Error

IMPORTANT:

Inserting the cutting tool less than 2/3rd the gripping length into the collet can damage the collet permanently. Full length of the gripping bore needs to be maintained to achieve maximum accuracy and safety. Collet accuracies are based on size-for-size conditions. Using the collapsible range can influence the accuracy and gripping powers. Never try to stretch the collets by clamping oversize cutting tools.

CV Shank

BT Shank

DV Shank

HSK Shank

Straight Shank

Collets/Sleeves

Accessories

Toolholding Technical Data

Toolholding Systems

Index

Collets and Sleeves

Double Angle (DA) Collet System



DA – Double Angle

- 1/32" [.031 (0,8 mm)] range of collapse.



DAC – Double Angle Coolant

- Rubber-filled slots seal coolant-fed tool applications.
- Suitable for coolant pressure up to 70 bar (1000 psi).
- Fits all standard DA-style collet chucks.
- .005 (0,13 mm) range of collapse.



DANP – Double Angle Non-Pullout – Weldon-Style

- Designed to grip end mills with Weldon-style shanks.
- Positive retention and drive provided by drive wedge in collet.
- Eliminates inaccuracy created by solid end mill adapters.
- Fits all standard DA-style collet chucks.
- .005 (0,13 mm) range of collapse.

CV Shank

BT Shank

DV Shank

HSK Shank

Straight Shank

Collets/Sleeves

Accessories

Toolholding Technical Data

Toolholding Systems

Index