

# TG Single-Angle Collet Systems



## Drilling – Milling – Tapping

**ERICKSON**

- The TG (Tremendous Grip) Single Angle Erickson™ collet system provides additional grip with improved concentricity.
- Maximum collapse is .016 (0,4 mm).
- Main application: drilling.
- Other applications: milling operations using end mills with the TGNP (non-pullout) collet, and tapping operations using the TGST collet.

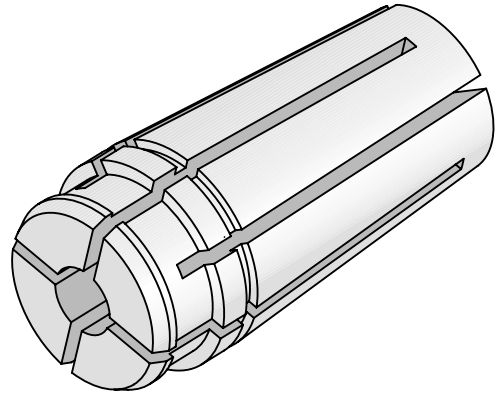

## TG-Style Collet Identification System

### Special Features

#### System Size

50  
75  
100  
150

C = coolant style - bonded  
HP = high-precision  
CHP = coolant / high-precision  
NP = non-pullout (end mill design)  
ST = solid tapping (slot for drive)  
STC = solid tapping / coolant (slot for drive)

#### Unit Size

M = metric  
" " = (left blank) collet number built in inch units.

**100 TG C 160 M**

Collet Style

Collet Bore Size

TG - Tremendous Grip  
Single Angle

**metric** 010 = 1 mm  
(xx.x) 160 = 16 mm  
245 = 24,5 mm

**inch** 0125 = 1/8"  
(x.xxx) 0500 = 1/2"  
1000 = 1"

## TG- and ER-Style (DIN 6499) Collet Accuracy

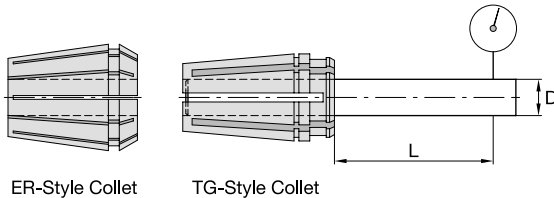

### IMPORTANT:

Inserting the cutting tool less than 2/3rd the gripping length into the collet can damage the collet permanently. Full length of the gripping bore needs to be maintained to achieve maximum accuracy and safety. Collet accuracies are based on size-for-size conditions. Using the collapsible range can influence the accuracy and gripping powers. Never try to stretch the collets by clamping oversize cutting tools.

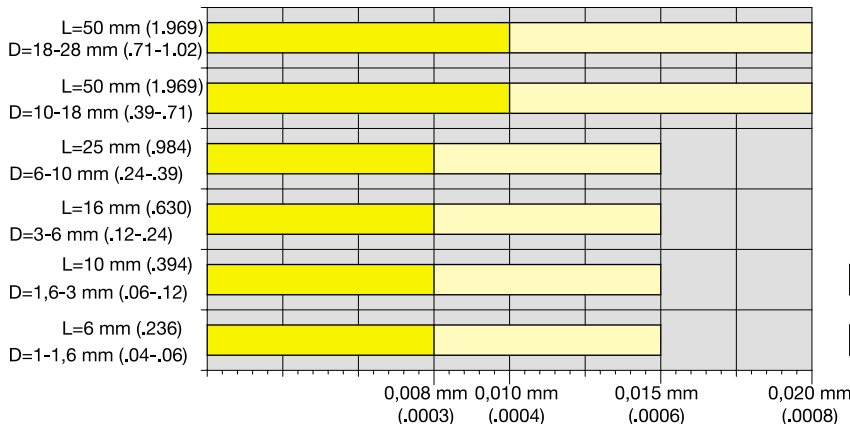

Runout

TGHP (precision) = DIN 6499 Class I

TG (standard) = ER - DIN 6499 Class II

Maximum Runout Error



## Single Angle (TG) Collets



### TG — Tremendous Grip

- Provides tremendous grip and accuracy for all drilling applications.
- 1/64 [.016 (0,4 mm)] range of collapse.
- Grips on back taper and margin of drill for maximum feed rates and more accurate holes.
- Manufactured to DIN 6499 Class 2 accuracy.

### TGC — Tremendous Grip Coolant

- Rubber-filled slots seal collet for coolant-fed tool applications.
- Suitable for coolant pressure up to 100 bar (1500 psi).
- Unique design features permit easy entry into nosepiece.
- Available from stock in all popular sizes.
- Fits all standard TG-style collets.
- .005 (0,13 mm) range of collapse.
- Design enables flutes of drills to enter collet, unlike competitive designs.

### TGHP — Tremendous Grip High Precision

- Twice as accurate as standard TG- and ER-style collets.
- Available from stock in all popular sizes.
- Can be used in all standard TG collet chucks.
- .010 (0,25 mm) range of collapse.
- Manufactured to DIN 6499 Class 1 accuracy.

### TGCHP — Tremendous Grip Coolant High Precision

- Rubber-filled slots seal collet for coolant-fed tool applications.
- Suitable for coolant pressure up to 100 bar (1500 psi).
- Unique design features permit easy entry into nosepiece.
- Available from stock in all popular sizes.
- Fits all standard TG-style collets.
- .005 (0,13 mm) range of collapse.
- Manufactured to DIN 6499 Class 1 accuracy.

### TGNP — Tremendous Grip Non-Pullout – Weldon-Style

- Positive retention and drive provided by drive wedge in collet.
- Eliminates inaccuracy created by solid end mill holders.
- .005 (0,13 mm) range of collapse.
- Fits all standard TG-style collet chucks.

### TGST — Tremendous Grip Single Angle Tap Collet

- Designed to grip the tap on the shank and square.
- Fits all standard TG-style collet chucks.
- .005 (0,13 mm) range of collapse.

### TGSTC — Tremendous Grip Single Angle Tap Collet Coolant-Style

- Rubber-filled slots seal collet for coolant-fed tool applications.
- Suitable for coolant pressure up to 70 bar (1000 psi).
- Designed to grip the tap on the shank and square.
- Fits all standard TG-style collet chucks.
- .005 (0,13 mm) range of collapse.

CV Shank

BT Shank

DV Shank

HSK Shank

Straight Shank

Collets/Sleeves

Accessories

Toolholding Technical Data

Toolholding Systems

Index