

TOP NOTCH Threading & Grooving Boring Bar Identification System

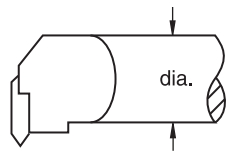

Inch

A two-digit number that indicates the bar diameter in 1/16-inch increments.



2. Bar Diameter

A 32

1. Bar Type

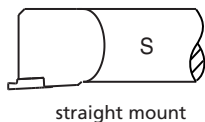
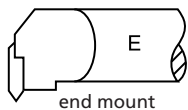
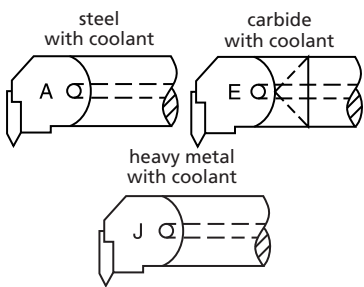

4. Insert Location

N E

3. Insert Holding Method



N* - TOP NOTCH



insert number	W1
1	.100
2	.150
3	.195
4	.255
5	.380
6	.383
8	.438

6. Insert Size

R 3 W

5. Hand of Bar

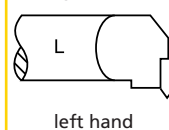
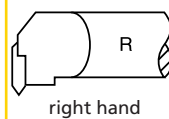

7. Additional Information

through-coolant interchangeable head

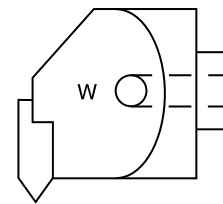

*Kennametal standard only.

Metric

bar diameter in millimeters.

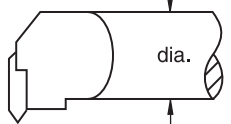

2. Bar Diameter

A 25

1. Bar Type

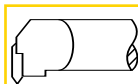
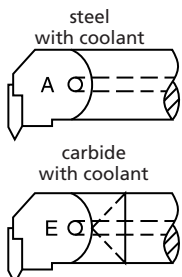

metric bars:
M = 150 mm
Q = 180 mm
R = 200 mm
S = 250 mm
T = 300 mm
U = 350 mm

3. Bar Length

R

4. Insert Holding Method

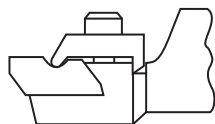

N* - TOP NOTCH

5. Insert Shape

N

6. Insert Location

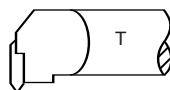

end mount

7. Rake Angle

T

9. Insert Size



insert number	(mm)	W1
1	3,54	.100
2	3,81	.150
3	5,35	.195
4	6,40	.255
5	9,65	.380
6	9,73	.383
8	11,13	.438

8. Hand of Bar

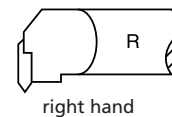

right hand

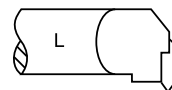

left hand

*Kennametal standard only.