

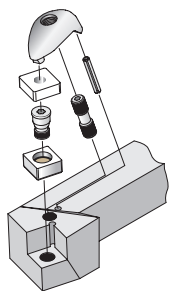

KENCLAMP



Shim Screw

Catalog number	Thread Size	Top Drive Torx plus	Bottom Drive	Recommended Torque		
				Nm	in-lbs	ft-lbs
KMSP39IP	M5 x 0,8	9IP	-	6	53	4
KMSP415IP	M6,3 x 1,0	15IP	-	6	53	4
KMSP4515IP	M6,3 x 1,0	15IP	-	6	53	4
KMSP515IP	M8 x 1,0	15IP	-	7	58	5
KMSP5515IP	M8 x 1,0	15IP	-	7	58	5
KMSP625IP	M10 x 1,0	25IP	-	17	150	12
KMSP840IP	M12 x 1,25	40IP	-	33	292	24

Clamp Screw

Catalog number	Thread Size	Top Drive Torx plus	Bottom Drive Torx plus	Recommended Torque		
				Nm	in-lbs	ft-lbs
STCM1115IP	M6 x 1,0	15IP	15IP	7	58	5
STCM119IP	M6 x 1,0	9IP	9IP	6	53	4
STCM1940IP	M10 x 1,25	40IP	40IP	33	292	24
STCM4127IP	M8 x 1,0	27IP	27IP	20	177	14
STCM425IP	M8 x 1,0	25IP	25IP	17	150	12
STCM825IP	M8 x 1,0	25IP	25IP	17	150	12

KENLEVER

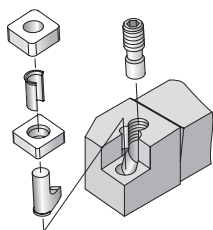

Lever Screw

Catalog number	Thread Size	Top Drive Torx plus	Bottom Drive Torx plus	Recommended Torque		
				Nm	in-lbs	ft-lbs
514.111	M5 x 0,8	8IP	-	2	18	1.5
514.112	M5 x 0,8	8IP	-	2	18	1.5
514.118	M6 x 1,0	10IP	10IP	4	35	3.0
514.122	M6 x 1,0	10IP	-	4	35	3.0
514.123	M8 x 1,0	15IP	15IP	7	58	5.0
514.124	M8 x 1,0	15IP	-	7	58	5.0
514.125	M8 x 1,0	15IP	-	7	58	5.0
514.128	M8 x 1,0	15IP	15IP	7	58	5.0
514.133	M10 x 1,0	25IP	25IP	12	106	9.0
514.138	M10 x 1,0	30IP	30IP	17	150	12.0

KENLOC

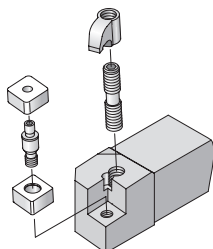

Lock Pin

Catalog number	Thread Size	Top Drive Hex (inch)	Bottom Drive Hex (inch)	Recommended Torque		
				Nm	in-lbs	ft-lbs
KL23	#8-32	-	1/16	1,5	13	1.0
KL33	#10-32	5/64	5/64	1,7	15	1.2
KL33L	#10-32	5/64	5/64	1,7	15	1.2
KL34	#10-32	5/64	5/64	1,7	15	1.2
KL34L	#10-32	5/64	5/64	1,7	15	1.2
KL44	1/4-28	3/32	3/32	3,3	30	2.5
KL46	1/4-28	3/32	3/32	3,3	30	2.5
KL46L	1/4-28	3/32	3/32	3,3	30	2.5
KL57	5/16-24	1/8	1/8	5,5	50	4.0
KL58	5/16-24	1/8	1/8	5,5	50	4.0
KL58L	5/16-24	1/8	1/8	5,5	50	4.0
KL68	3/8-24	9/64	9/64	8,0	70	5.6
KL68L	3/8-24	9/64	9/64	8,0	70	5.6
KL810	7/16-20	5/32	5/32	9,0	80	6.4
KLC33	M5 x 0,8	5/64	5/64	1,7	15	1.2
KLC33L	M5 x 0,8	5/64	5/64	1,7	15	1.2
KLC34L	M5 x 0,8	5/64	5/64	1,7	15	1.2
KLC43	M5 x 0,8	5/64	5/64	1,7	15	1.2
KLC44	M6,3 x 1	3/32	3/32	3,3	30	2.5
KLC46	M6,3 x 1	3/32	3/32	3,3	30	2.5
KLC46L	M6,3 x 1	3/32	3/32	3,3	30	2.5
KLC46S	M6,3 x 1	3/32	3/32	3,3	30	2.5
KLC54	M6,3 x 1	3/32	3/32	3,3	30	2.5
KLC56	M8 x 1	1/8	1/8	5,5	50	4.0
KLC58	M8 x 1	1/8	1/8	5,5	50	4.0
KLC68	M10 x 1	9/64	9/64	8,0	70	5.6
KLC810	M12 x 1,25	5/32	5/32	9,0	80	6.4

Clamp Screw

Catalog number	Thread Size	Top Drive Hex (inch)	Bottom Drive Hex (inch)	Recommended Torque		
				Nm	in-lbs	ft-lbs
STC2	5/16 - 24	5/32	5/32	10,8	96	8
STC3	1/2 - 20	1/4	1/4	40,3	357	30
STC4	5/16 - 24	5/32	5/32	10,8	96	8
STC5	10 - 32	3/32	3/32	2,3	21	1.6
STC8	5/16 - 24	5/32	5/32	10,8	96	8
STC9	10 - 32	3/32	3/32	2,3	21	1.6
STC11	1/4 - 28	1/8	1/8	5,4	48	4
STC12	1/4 - 28	1/8	1/8	5,4	48	4
STC19	3/8 - 24	3/16	3/16	18,8	167	13.9
STC20	1/4 - 28	1/8	1/8	5,4	48	4
STC25	10 - 32	3/32	3/32	2,3	21	1.6
STC26	1/4 - 28	1/8	1/8	5,4	48	4
STC27	8 - 36	5/64	5/64	1,4	12	1
STC30	6 - 40	1/16	1/16	0,7	6	.5
STC32	1/4 - 28	1/8	1/8	5,4	48	4
STC34	10 - 32	3/32	3/32	2,3	21	1.6
STC35	1/4 - 28	1/8	1/8	5,4	48	4
STC36	1/4 - 28	3/32	3/32	2,3	21	1.6
STCC-8	M8 X 1	9/64	9/64	11,8	105	8.8
STCC-9	M5x0,8	3/32	3/32	3,1	28	2.3
STCC-11	M6X1	1/8	1/8	5,1	45	3.8
STCC-20	M6x1	1/8	1/8	5,1	45	3.8
STCC-37	M8x1	3/32	3/32	11,8	105	8.8
STCC-38	M5x0,8	5/64	5/64	3,1	28	2.3
STCC-39	M10 X 1,25	1/8	1/8	35,0	206	25.9
STCC-40	M6x1	3/32	3/32	5,1	45	3.8

KENLOC

KENDEX

SCREW-ON

APPLICATION-SPECIFIC

GROOVING / CUT-OFF

THREADING

APPENDIX



KENLOC

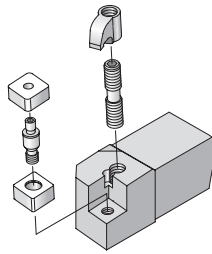

Lock Pin

Catalog number	Thread Size	Top Drive	Bottom Drive	Recommended Torque		
		Hex (mm)	Hex (mm)	Nm	in-lbs	ft-lbs
KLM23	M4 x 0,7	-	1,5	1,5	13	1.0
KLM33	M5 x 0,8	2,0	2,0	1,7	15	1.2
KLM33L	M5 x 0,8	2,0	2,0	1,7	15	1.2
KLM34	M5 x 0,8	2,0	2,0	1,7	15	1.2
KLM34L	M5 x 0,8	2,0	2,0	1,7	15	1.2
KLM43	M5 x 0,8	2,0	2,0	1,7	15	1.2
KLM44	M6,3 x 1	2,5	2,5	3,3	30	2.5
KLM46	M6,3 x 1	2,5	2,5	3,3	30	2.5
KLM46L	M6,3 x 1	2,5	2,5	3,3	30	2.5
KLM46S	M6,3 x 1	2,5	2,5	3,3	30	2.5
KLM54	M6,3 x 1	2,5	2,5	3,3	30	2.5
KLM56	M8 x 1	3,0	3,0	5,5	50	4.0
KLM58	M8 x 1	3,0	3,0	5,5	50	4.0
KLM58L	M8 x 1	3,0	3,0	5,5	50	4.0
KLM66	M10 x 1	4,0	4,0	8,0	70	5.6
KLM66L	M10 x 1	4,0	4,0	8,0	70	5.6
KLM68	M10 x 1	4,0	4,0	8,0	70	5.6
KLM68L	M10 x 1	4,0	4,0	8,0	70	5.6
KLM810	M12 x 1,25	4,0	4,0	9,0	80	6.4

Clamp Screw

Catalog number	Thread Size	Top Drive	Bottom Drive	Recommended Torque		
		Hex (mm)	Hex (mm)	Nm	in-lbs	ft-lbs
STCM4	M8 x 1	4,0	4,0	17,0	150	12.0
STCM5	M5 x 0,8	2,5	2,5	4,0	35	3.0
STCM8	M8 x 1	4,0	4,0	17,0	150	12.0
STCM9	M5 x 0,8	2,5	2,5	4,0	35	3.0
STCM11	M6 x 1	3,0	3,0	6,0	53	4.4
STCM19	M10 x 1,25	5,0	5,0	8,0	71	5.9
STCM20	M6 x 1	3,0	3,0	7,0	62	5.2
STCM24	M10 x 1,25	5,0	5,0	33,0	292	24.3
STCM25	M5 x 0,8	2,5	2,5	4,0	35	3.0
STCM26	M6 x 1	3,0	3,0	7,0	62	5.2
STCM27	M4 x 0,7	2,0	2,0	2,1	19	1.5
STCM32	M6 x 1	3,0	3,0	7,0	62	5.2
STCM35	M6 x 1	3,0	3,0	7,0	62	5.2
STCM37	M8 x 1	2,5	2,5	4,2	37	3.1
STCM38	M5 x 0,8	2,0	2,0	2,1	19	1.5
STCM39	M10 x 1,25	3,0	3,0	8,0	71	5.9
STCM40	M6 x 1	2,5	2,5	4,2	37	3.1

WEDGELOCK

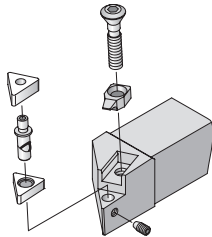

Lock Pin

Catalog number	Thread Size	Top Drive	Bottom Drive	Recommended Torque		
		Hex (inch)	Hex (inch)	Nm	in-lbs	ft-lbs
FPE5	#10-24	1/16	3/32	1,5	13	1.0
FPE6	#10-24	3/32	3/32	3,3	30	2.5
FP453	M4 x 0,5	Torx T10	Torx T10	1,7	15	1.2
FP477	M4 x 0,5	Torx T10	Torx T10	1,7	15	1.2
192.159	M6 x 1	Hex (mm) 3	-	4,0	35	3.0
192.636	M4 x 0,7	Torx T15	-	2,6	23	2.0

Clamp Screw/Assembly

Catalog number	Thread Size	Top Drive	Bottom Drive	Recommended Torque		
		Hex (inch)	Hex (inch)	Nm	in-lbs	ft-lbs
S986	1/4 - 20	5/32	-	8,0	73	6.1
S987	5/16 - 18	3/16	-	9,0	80	6.6
MS1372	M6 x 1,0	Torx T25	-	9,0	80	6.6
551.125	M5 x 0,8	Hex (mm) 3	Hex (mm) 3	7,0	58	5.0
551.126	M6 x 1,0	3	3	7,0	58	5.0
551.131	M5 x 0,8	3	3	7,0	58	5.0

TNT/MTS

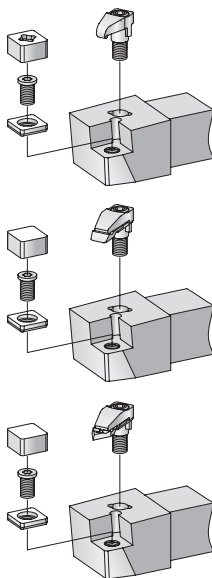

Shim Screw

Catalog number	Thread Size	Top Drive	Bottom Drive	Recommended Torque		
		Torx	Drive	Nm	in-lbs	ft-lbs
554.260	M6 x 1,0	T20	-	5,0	44	4.0
554.261	M8 x 1,0	T25	-	8,0	71	6.0
554.252	M6 x 1,0	Hex (mm) 2,5	-	3,0	27	2.2
554.253	M8 x 1,0	3,0	-	6,0	53	4.0
554.254	M5 x 0,8	2,5	-	3,0	27	2.2

Clamp Assembly/Lock Pin

Catalog number	Thread Size	Top Drive	Bottom Drive	Recommended Torque		
		Torx	Torx	Nm	in-lbs	ft-lbs
551.326	M8 x 1,25	T25	T25	8,0	71	6.0
551.327	M8 x 1,25	T25	T25	8,0	71	6.0
551.342	M8 x 1,25	T25	T25	8,0	71	6.0
551.251	M8 x 1,25	Hex (mm) 4,0	Hex (mm) 4,0	8,0	71	6.0
551.252	M8 x 1,25	4,0	4,0	8,0	71	6.0
551.253	M8 x 1,25	4,0	4,0	8,0	71	6.0
551.254	M8 x 1,25	4,0	4,0	8,0	71	6.0
551.255	M8 x 1,25	4,0	4,0	8,0	71	6.0
551.256	M8 x 1,25	4,0	4,0	8,0	71	6.0
551.257	M8 x 1,25	4,0	4,0	8,0	71	6.0
551.260	M8 x 1,25	4,0	4,0	8,0	71	6.0
551.261	M8 x 1,25	4,0	4,0	8,0	71	6.0
551.316	M8 x 1,25	4,0	4,0	8,0	71	6.0
551.317	M8 x 1,25	4,0	4,0	8,0	71	6.0
551.332	M8 x 1,25	4,0	4,0	8,0	71	6.0
551.333	M8 x 1,25	4,0	4,0	8,0	71	6.0
554.016	M6 x 1,0	2,5	2,5	3,0	27	2.2
554.017	M8 x 1,0	3,0	3,0	6,0	53	4.0
554.018	M5 x 0,8	2,0	2,0	1,7	15	1.3



SCREW-ON

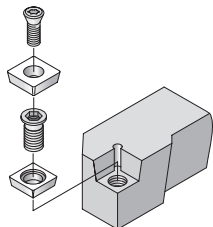

Shim Screw

Catalog number	Thread Size	Top Drive		Recommended Torque		
		Hex (inch)	Bottom Drive	Nm	in-lbs	ft-lbs
MS1028	M3 x 0,5 (INT) M5 x 0,8 (EXT)	3/32	-	1,7	15	1.00
SRS3	M3,5 x 0,6 (INT) M5 x 0,5 (EXT)	Hex (mm)	-	2,2	20	1.66
SRS4	M4 x 0,5 (INT) M6 x 0,75 (EXT)	4,0	-	2,6	23	2.00
SRS5	M5 x 0,8 (INT) M8 x 0,75 (EXT)	5,0	-	2,8	25	2.00
SRS6	M6 x 1,0 (INT) M10 x 0,75 (EXT)	6,0	-	3,4	30	2.50

Insert Screw

Catalog number	Thread Size	Top Drive		Recommended Torque		
		Torx	Bottom Drive	Nm	in-lbs	ft-lbs
MS1017	M2,5 x 0,45	T7	-	1,00	8	0.60
MS1018	M4 x 0,7	T15	-	2,60	23	2.00
MS1019	M3 x 0,5	T8	-	1,70	15	1.00
MS1022	M3 x 0,5	T8	-	1,70	15	1.00
MS1023	M2,5 x 0,45	T7	-	1,00	8	0.60
MS1026	M2,2 x 0,45	T7	-	1,00	8	0.60
MS1027	M3 x 0,5	T9	-	1,70	15	1.00
MS1129	M4,5 x 0,75	T15	-	3,80	34	3.00
MS1152	M2,2 x 0,45	T7	-	1,00	8	0.60
MS1153	M2,5 x 0,45	T7	-	1,00	8	0.60
MS1154	M3 x 0,5	T9	-	1,70	15	1.00
MS1155	M3,5 x 0,6	T15	-	1,70	15	1.00
MS1156	M3,5 x 0,6	T15	-	1,70	15	1.00
MS1157	M4 x 0,5	T15	-	2,60	23	2.00
MS1158	M4 x 0,5	T15	-	2,60	23	2.00
MS1159	M5 x 0,8	T20	-	5,10	45	4.00
MS1160	M5 x 0,8	T20	-	5,10	45	4.00
MS1161	M6 x 1	T25	-	8,80	77	6.00
MS1162	M6 x 1	T25	-	8,80	77	6.00
MS1163	M8 x 1,25	T30	-	21,00	186	15.00
MS1438	M1,8 x 0,35	T5	-	0,34	3	0.25
MS1454	M1,8 x 0,35	T5	-	0,34	3	0.25
MS1571	M5 x 0,8	T20	-	5,10	45	4.00
MS1863	M2 x 0,4	T6	-	0,47	4	0.33
MS1864	M2,5 x 0,45	T8	-	1,00	8	0.60
MS1871	M4 x 0,7	T15	-	2,60	23	2.00
MS1933	M2,2 x 0,45	T7	-	1,00	8	0.60
MS1939	M2,5 x 0,45	T7	-	1,00	8	0.60
SSA3T	#5-40	T10	-	1,70	15	1.00
SSA4T	#8-32	T20	-	2,60	23	2.00
SSN2T	M2,6 x 0,45	T8	-	1,10	10	0.80

KENLOC

KENDEX

SCREW-ON

APPLICATION-SPECIFIC
KENNAMETAL CLASSIC PRODUCTS

GROOVING / CUT-OFF

THREADING

APPENDIX



A4

Clamp Screw

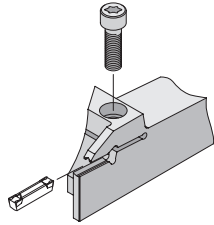

Catalog number	Thread Size	Top Drive Torx	Bottom Drive	Recommended Torque	
				Nm	in-lbs
MS1162	M6 x 1,0	T25	-	8.8	77
MS1490	M8 x 1,25	T45	-	21	186
MS1595	M6 x 1,0	T30	-	8.8	77
MS1970	M6 x 1,0	T30	-	8.8	77
MS2002	M6 x 1,0	T25	-	8.8	77
MS2089	M5 x 0,8	25IP	-	5.1	45
MS2091	M5 x 0,8	25IP	-	5.1	45
		Hex (mm)			
MS2090	M3 x 0,5	1,5	-	1.7	15
193.407	M5 x 0,8	2,5	-	5.1	45

A3

Clamp Screw

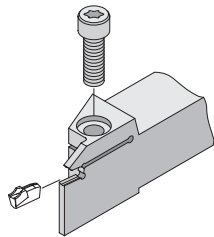

Catalog number	Thread Size	Top Drive Torx	Bottom Drive	Recommended Torque	
				Nm	in-lbs
MS1160	M5 x 0,8	20	-	5.1	45
MS1162	M6 x 1,0	25	-	8.8	77
MS1163	M8 x 1,25	30	-	21	186
MS1488	M3,5 x 0,6	15	-	1.7	15
MS1571	M5 x 0,8	20	-	5.1	45
MS1595*	M6 x 1,0	30	-	8.8	77
MS1595	M6 x 1,0	30	-	8.8	77
MS1875	M8 x 1,25	45	-	21	186
MS1944	M4 x 0,5	25	-	5.1	45
MS2002	M6 x 1,0	25	-	8.8	77
191.916	M4 x 0,5	15	-	2.6	23

* for toolholder grooving depth greater than or equal to 26 mm

Features and Compatibility of the Torx Plus and the Torx Drive System



Torx Plus Drive System

The Torx Plus drive system utilizes ellipses to define its geometry and improves upon the original Torx design.



Torx Drive System

The Torx drive system utilizes circles to define its geometry and offers many advantages over other systems.



System Compatibility

The Torx Plus drive system recess is compatible with existing Torx drive tools for field service concerns.